

**DOCUMENTS
ON DEPOSIT**



**These documents should
remain available for public
inspection until
13th February 2023**

THE KENT COUNTY COUNCIL
(VARIOUS ROADS, BOROUGH OF SWALE)
WAITING RESTRICTIONS AND STREET PARKING
PLACES (AMENDMENT 40) ORDER 2023

Please return to:

**Engineering Team
Swale Borough Council
Swale House
East Street
Sittingbourne
Kent
ME10 3HT**

At expiry of deposit period

STATEMENT of REASON



**THE KENT COUNTY COUNCIL (VARIOUS ROADS, BOROUGH OF
SWALE)
(WAITING RESTRICTIONS AND STREET PARKING PLACES)
(AMENDMENT NO.40) ORDER 2023
Road Traffic Regulation Act 1984**

To facilitate the safe passage of vehicles, in Tanners Street, Faversham, it is proposed to install a section of double yellow lines and reduce the length of a parking bay and extend another section of parking bay to compensate for the loss of on-street parking capacity. It is also proposed to extend the existing double yellow lines opposite 136 The Street, Boughton-under-Blean, by 2 metres to facilitate the safe passage of vehicles.

It is proposed to install new, or formalise the existing, disabled persons' parking bays at the side of Salix Copiers in Westgate Road, Faversham, outside 35 Queenborough Road, Halfway, outside 29 Acorn Street, Sheerness, outside 9 Bucklers Close, Warden Bay, and outside 86 Langley Road, and 45 and 47 Prince Charles Avenue in Sittingbourne.

For the following purposes:

- **To avoid danger to persons or other traffic using the road or any other road or to prevent the likelihood of any such danger arising;**
- **To facilitate the passage on the road or any other road of any class of traffic (including pedestrians).**

Dated 15th December 2022
MIKE KNOWLES

**THE KENT COUNTY COUNCIL (VARIOUS ROADS, BOROUGH OF SWALE)
(WAITING RESTRICTIONS AND STREET PARKING PLACES)
(AMENDMENT No.40) ORDER 2023**

The Kent County Council, acting as the local traffic authority and in exercise of its powers under sections 1(1), 2(1) to (3), 3(2), 4(1) and (2), 32(1), 35(1), 45, 46, 49 and 53 of the Road Traffic Regulation Act 1984, ('the Act') and of all other enabling powers, and after consultation with the chief officer of police in accordance with Part III of Schedule 9 to the Act, propose to make the following Order:-

A - This Order may be cited as "The Kent County Council (Various Roads, Borough of Swale) (Waiting Restrictions and Street Parking Places) Amendment No.40 Order 2023" ('this Order') and shall come into force on the xx day of xxxxx 2023.

B - The "Kent County Council (Various Roads, Borough of Swale) (Waiting Restrictions and Street Parking Places) (Consolidation) Order 2019" ('the 2019 Order') shall have effect as though -

In the Schedules to the 2019 Order

FIRST SCHEDULE

Roads in Faversham

Tanners Street

The following shall be inserted in the First Schedule of the 2019 Order (*No Waiting At Any Time*) in place of the existing entry:

- TANNERS STREET (1) On the eastern ~~and south-eastern~~ side
- (a) from the Junction with West Street to a point 4 metres north east of the north-eastern boundary of 1 Tanners Street;
 - (b) between points 11 metres north and ~~10~~ 16 metres south of the centre of the Junction with Napleton Road;
 - (c) from a point in line with the boundary of 19/20 Tanners Street for a distance of 12.5 metres in a north-easterly direction;
 - (~~e~~d) from the northern building line of 28 Tanners Street for a distance of 3 metres in a northerly direction;
 - (~~d~~e) between the southern boundary of 32 Tanners Street and the southern boundary of 1 Fairlight Cottages Tanners Street;
 - (~~e~~f) from a point 10 metres north of the Junction with South Road to that Junction.
- (2) On the western side from the Junction with West Street to the Junction with South Road.

- (3) Around the full circumference of the traffic island at the Junction of Tanners Street and West Street.

The Street, Boughton-Under-Blean

The following shall be inserted in the First Schedule of the 2019 Order (*No Waiting At Any Time*) in place of the existing entry:

THE STREET, BOUGHTON-UNDER-BLEAN

(1) On the northern side

- (a) from the changeover of Stockers Hill to a point 2 metres west of the western boundary of 250 The Street;
- (b) from a point 1 metre west of the opposite eastern building line of 179 The Street to a point in line with the western building line of 220 The Street;
- (c) from a point 2 metres west of the boundary of 192/194 The Street to a point in line with the western building line of 188 The Street;
- (d) from a point 2 metres west of the western kerbline of School Lane to point 3 metres west of the boundary of 160/162 The Street;
- (e) on the northern side of the spur road, from a point in line with the eastern building line of 142 The Street for the full length of the spur road to the Junction with The Street, at a point 3 metres east of the eastern building line of 112 The Street;
- (f) from the eastern side of the Junction with Staplestreet Road, east to the changeover point of The Street/Canterbury Road, opposite the Junction of Horselees Road.

(2) On the southern side

- (a) from a point 1 metre east of the opposite boundary of 260/262 The Street to a point 1 metre east of the opposite western building line of 248 The Street;
- (b) from a point 3 metres west of the eastern building line of 205 The Street to a point 2 metres east of the western building line of 203 The Street;
- (c) from a point 1 metre west of the eastern building line of 179 The Street to a point in line with the opposite western building line of 220 The Street;
- (d) from a point 2 metres west of the opposite boundary of 192/194 The Street to a point 5 metres east of the western building line of 159 The Street;

- (e) from a point in line with the boundary of 125/127 The Street to a point 1 metre east of the boundary of 121/123 The Street;
- (f) between points 13 metres west and 15 metres east of the centre of the Junction of Arthur Kennedy Close;
- (g) on the southern side of the spur road, from the northern kerbline of The Street at the western Junction to a point 2 metres east of ~~in line with~~ the opposite boundary of 136/138 The Street;
- (h) on the southern side of the spur road, from the northern kerbline of The Street at the eastern Junction to a point opposite the centre of 120 The Street;
- (i) between points 20 metres west and 20 metres east of centre of the Junction of The Ridgeway;
- (j) from a point in line with the western boundary of 11 The Street, to a point in line with the boundary of 3a/5 The Street;
- (k) from a point in line with the boundary of 1 The Street/Woodmans Hall to the Junction of Horselees Road.

Roads in Sittingbourne and Milton

Chalkwell Road

The following shall be inserted in the First Schedule of the 2019 Order (*No Waiting At Any Time*) in place of the existing entry:

CHALKWELL ROAD (1) On the eastern side

- (a) from the Junction with London Road ~~for a distance of 19 metres in a northerly direction~~ to a point in line with the southern boundary of 144 Chalkwell Road;
- (b) from a point 7 metres north of the boundary of 128/130 Chalkwell Road for a distance of 28 metres in a northerly direction.

(2) On the western side

- (a) from the Junction with London Road to the Junction with Wellwinch Road;
- (b) from the northern kerbline of Springfield Road for a distance of 10 metres in a northerly direction;

(c) from the southern kerbline of Springfield Road for a distance of 10 metres in a southerly direction.

(3) On the north-western side

(a) between points 10 metres north-east and 10 metres south-west of the Junction with Hythe Road;

(b) from a point 4 metres south-west of the north-eastern boundary of 1 Alexander Court for a distance of 18 metres in a north-easterly direction.

(4) On the south-eastern side from a point in line with the boundary of 20/22 Chalkwell Road for a distance of 20 metres in a north-easterly direction.

THIRD SCHEDULE

The following shall be inserted in the Third Schedule of the 2019 Order (*Daytime Waiting Restrictions*) in place of the existing entry:

Chalkwell Road

1	2	3	4
Name of Road	Length of Road	Days on which restriction applies	Times at which restriction applies
Roads in Sittingbourne and Milton			
CHALKWELL ROAD	(1) On the eastern side (a) from a point 37 metres north of the Junction with Barkers Court in line with the southern boundary of 144 Chalkwell Road to a point 7 metres north of the boundary of 128/130 Chalkwell Road; (b) from a point 35 metres north of the boundary of 128/130 Chalkwell Road to the Junction with Watsons Hill.	Monday to Saturday	8.00am to 6.30pm

FIFTH SCHEDULE

The following shall be inserted in the Fifth Schedule of the 2019 Order (*Residents Parking*) in place of the existing entry:

1	2	3	4	5
Name of Road	Length of Road	Days and times on which restriction applies	Maximum Permitted waiting time	Period to elapse since last period of Permitted parking
Roads in Faversham				
TANNERS STREET	<p>On the eastern side</p> <p>(a) between a point 4 metres south-west of the north-east boundary of 10a and a point 11 metres north of the centre of the Junction with Napleton Road;</p> <p>(b) from a point 10 metres south of the centre of the Junction with Napleton Road for a distance of 10 metres in a southerly direction;</p> <p>(c) from a point in line with the northern boundary of 18/19 Tanners Street to a point 3 metres north of the northern building line of 28 Tanners Street;</p> <p>(d) from the northern building line of 28 Tanners Street to the southern boundary of 32 Tanners Street;</p> <p>(e) from the southern boundary of 1 Tanners Street to a point 15 metres north of the centre of the Junction with South Road.</p>	<p>Monday to Saturday</p> <p>8.00am to 10.00pm</p>	30 minutes	1 hour

SEVENTH SCHEDULE

The following shall be inserted in the Seventh Schedule of the 2019 Order (*Parking Places for Disabled Persons Vehicles*) in place of the existing entry or in the correct alphabetical sequence:

Roads in Faversham		
WESTGATE ROAD	FAVERSHAM	On the western side, between point 12.5 metres and 18 metres north of the northern kerbline of Whitstable Road.

Roads on the Isle of Sheppey		
QUEENBOROUGH ROAD	HALFWAY	(1) On the north side, across the frontage of 82 Queenborough Road; (2) In the cul-de-sac, perpendicular to the frontage of 37 Queenborough Road; (3) In the cul-de-sac, perpendicular to the frontage of 39 Queenborough Road; (4) In the cul-de sac, perpendicular to the frontage of 35 Queenborough Road.
ACORN STREET	SHEERNESS	On the north east side, across the frontage of 29 Acorn Street
BUCKLERS CLOSE	WARDEN BAY	Across the frontage of 9 Bucklers Close, perpendicular to the kerb

Roads in Sittingbourne and Milton	
LANGLEY ROAD	(1) From a point in line with the boundary of 13/15 Langley Road for a distance of 6.6 metres in a south-westerly direction; (2) Across the frontage of 86 Langley Road.
PRINCE CHARLES AVENUE	(1) On the western side (a) across the frontage of 53 Prince Charles Avenue; (b) across the frontage of 45 Prince Charles Avenue;

Roads in Sittingbourne and Milton	
	<p>(c) across the frontage of 47 Prince Charles Avenue.</p> <p>(2) On the south eastern side;</p> <p>(a) across the frontage of 38 Prince Charles Avenue</p>

Given under the Common Seal of the Kent County Council

This xx day of xxxxxx 2023

THE COMMON SEAL OF THE
KENT COUNTY COUNCIL was
hereunto affixed in the
presence of:-

Authorised Signatory



**THE KENT COUNTY COUNCIL (VARIOUS ROADS, BOROUGH OF SWALE)
(WAITING RESTRICTIONS AND STREET PARKING PLACES)
(AMENDMENT NO.40) ORDER 2023**

PLANS OF PROPOSED AMENDMENTS

Tanners Street, Faversham – New Double Yellow Lines and Reduced Parking Bay (Plan 1 of 2)

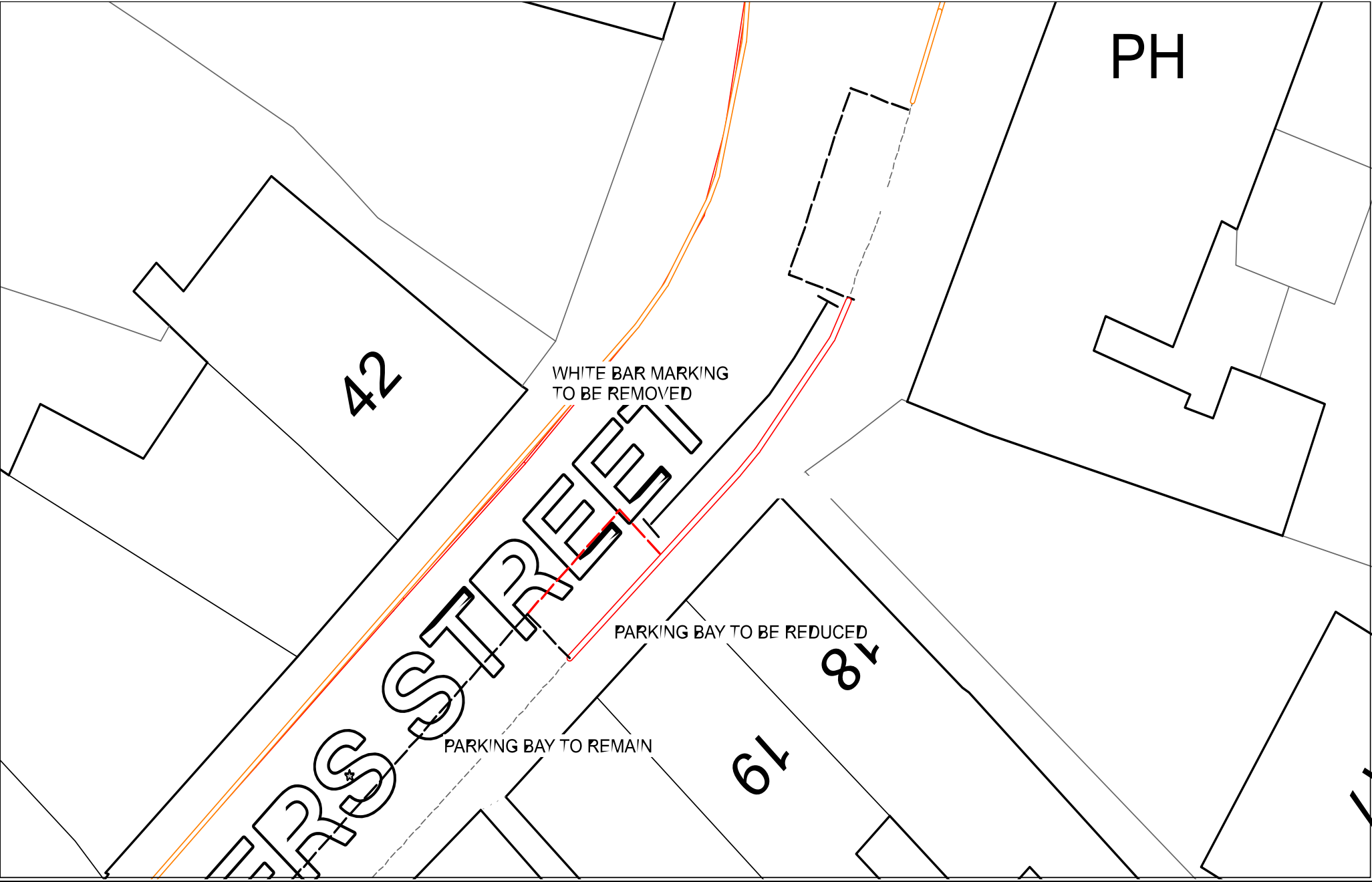

Tanners Street, Faversham – Double Yellow Lines Reduced and Parking Bay Increased (Plan 2 of 2)



The Street, Boughton-under-Blean – Proposed Extension to Existing Double Yellow Lines

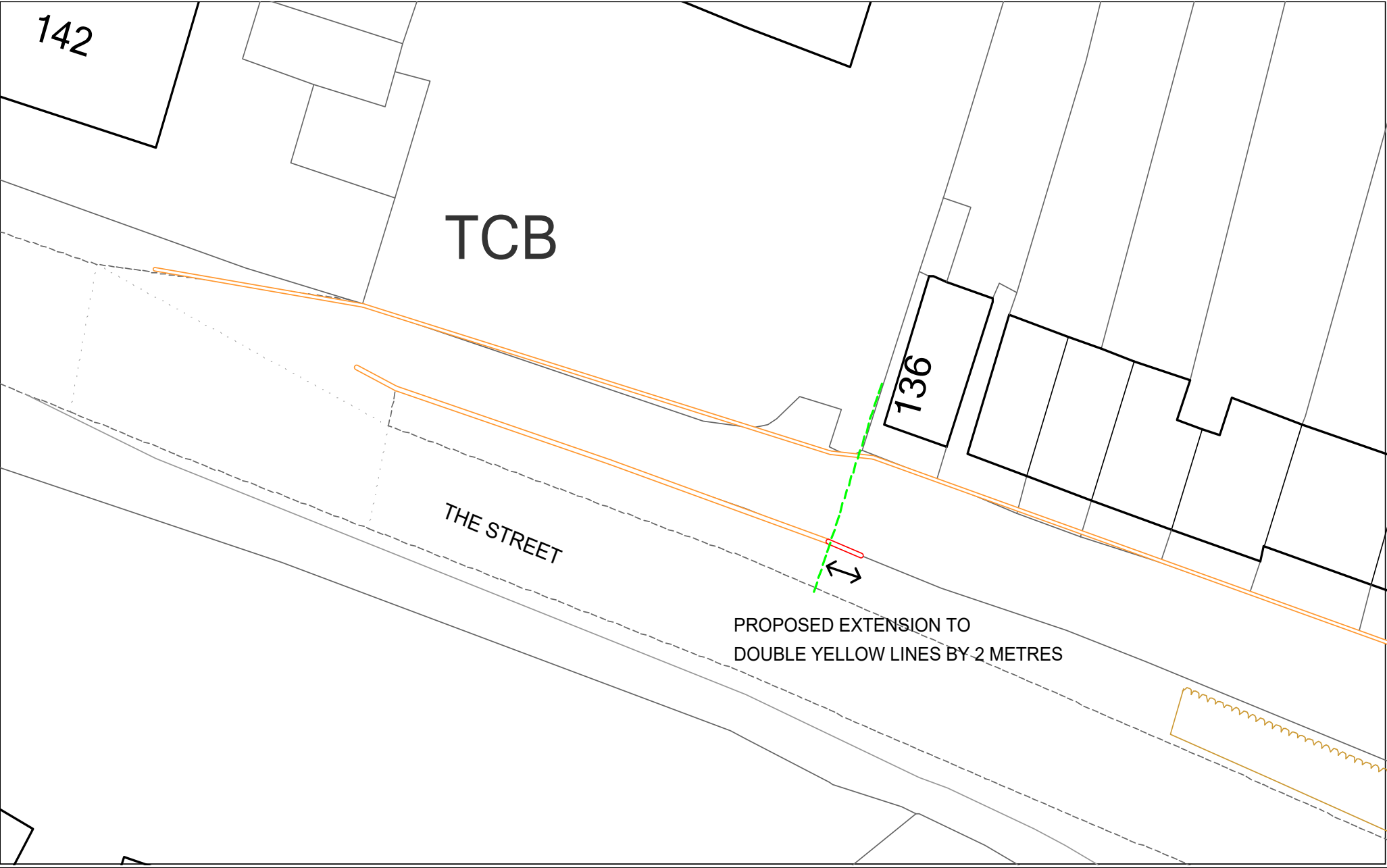

Westgate Road, Faversham – New Disabled Persons' Parking Bay/Formalising of Existing Bay

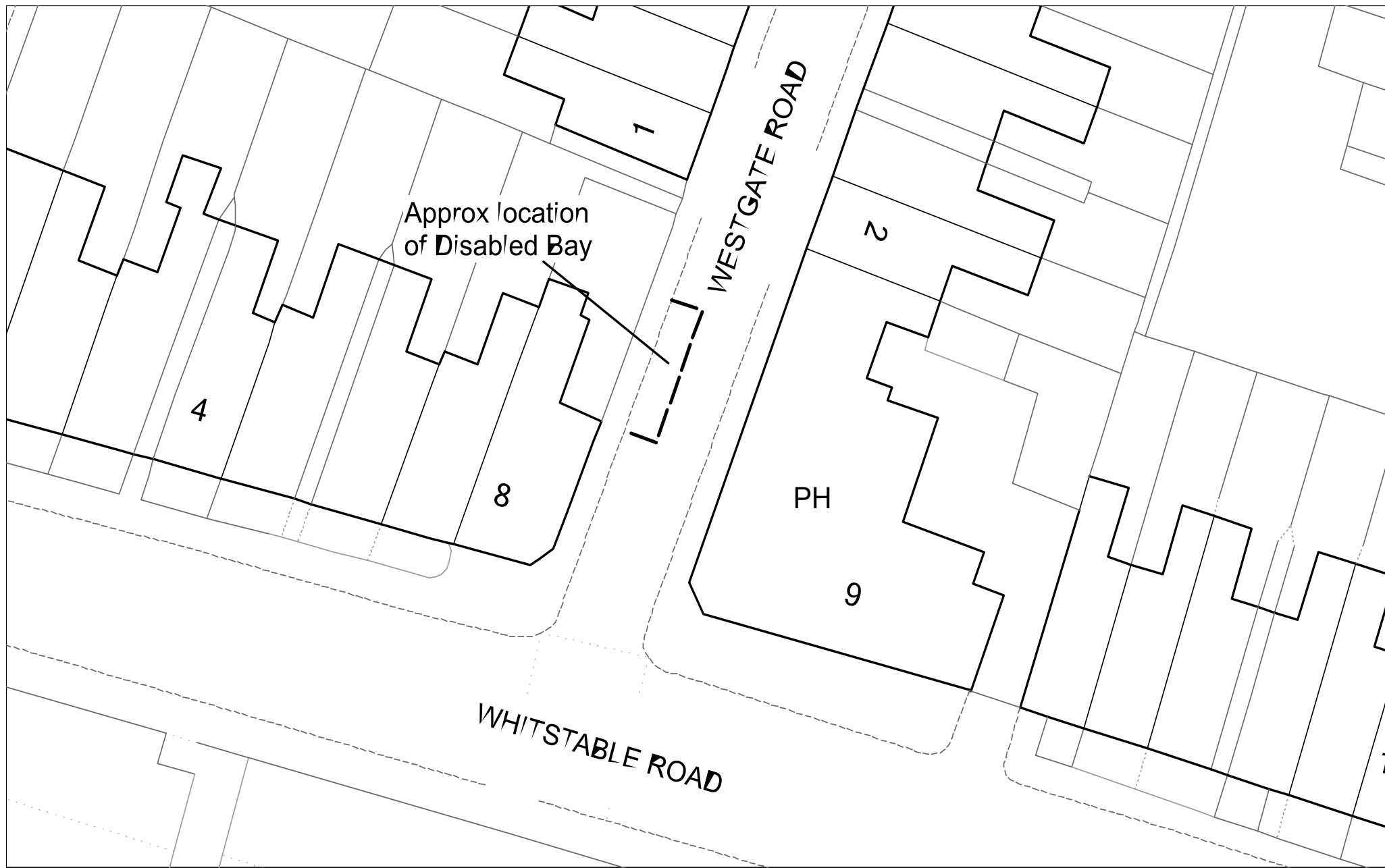

Outside 35 Queenborough Road, Halfway – New Disabled Persons' Parking Bay/Formalising of Existing Bay

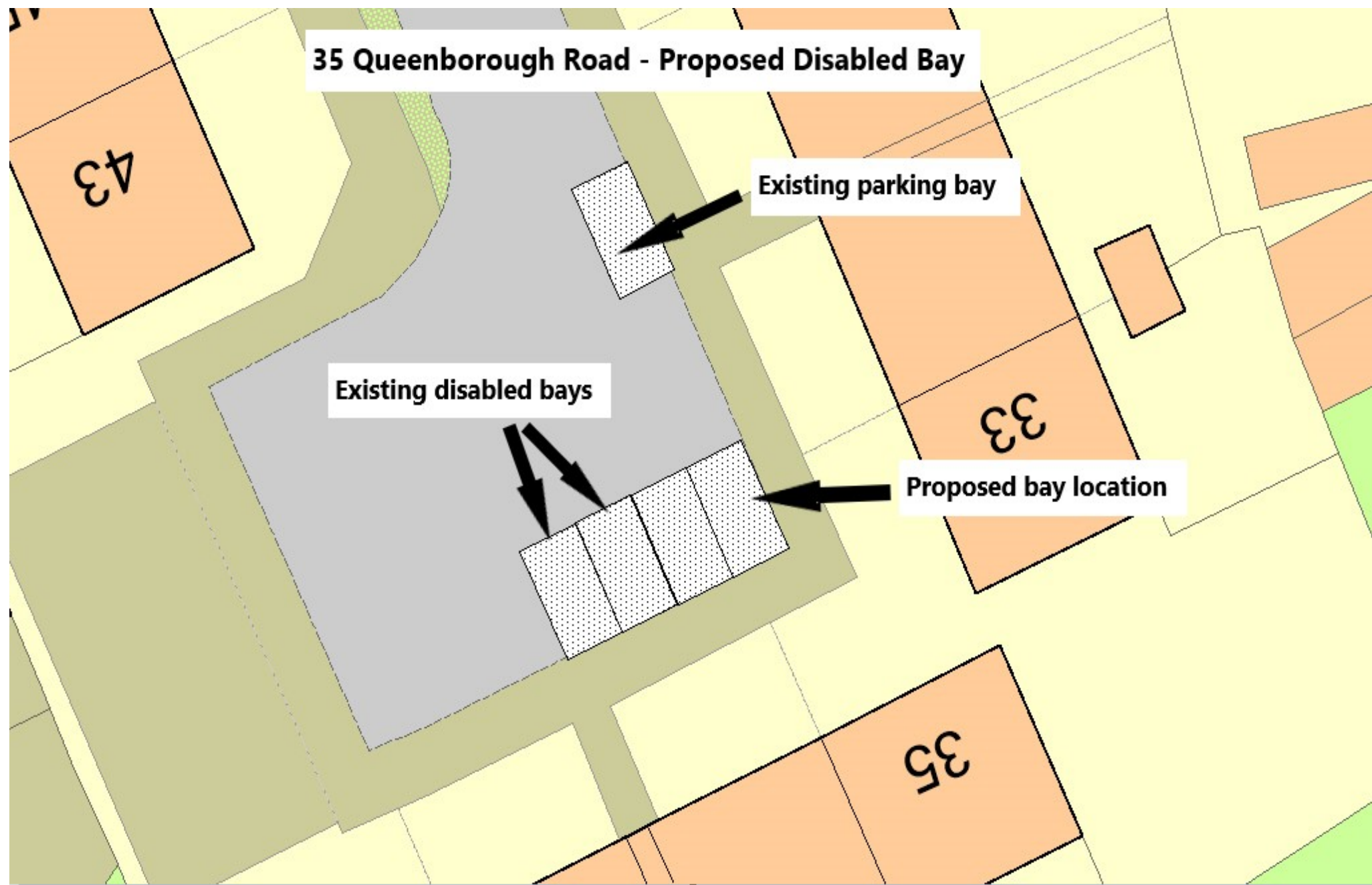

Outside 29 Acorn Street, Sheerness – New Disabled Persons' Parking Bay/Formalising of Existing Bay



Outside 9 Bucklers Close, Warden Bay – New Disabled Persons' Parking Bay/Formalising of Existing Bay

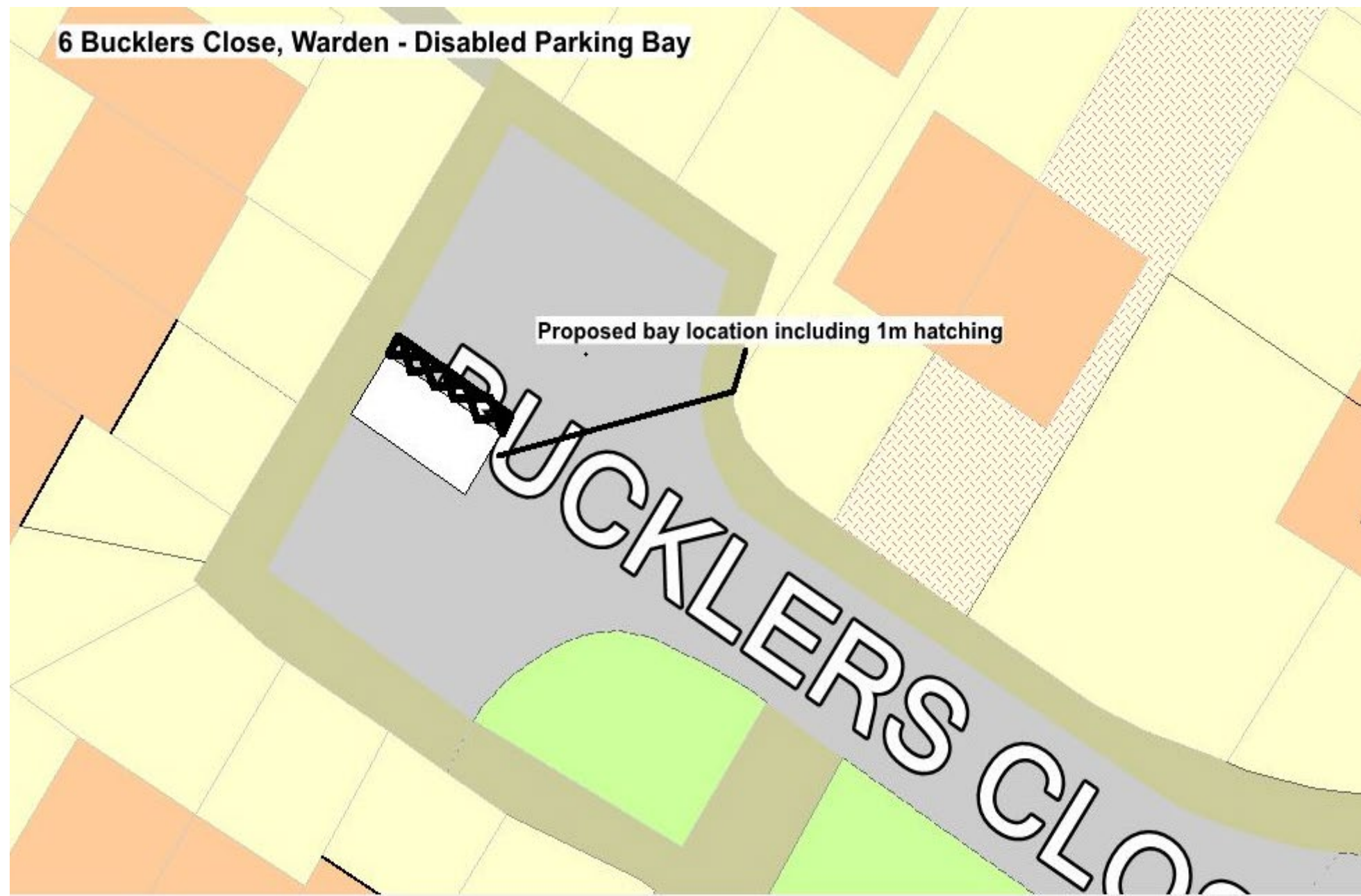

Outside 86 Langley Road, Sittingbourne – New Disabled Persons' Parking Bay/Formalising of Existing Bay

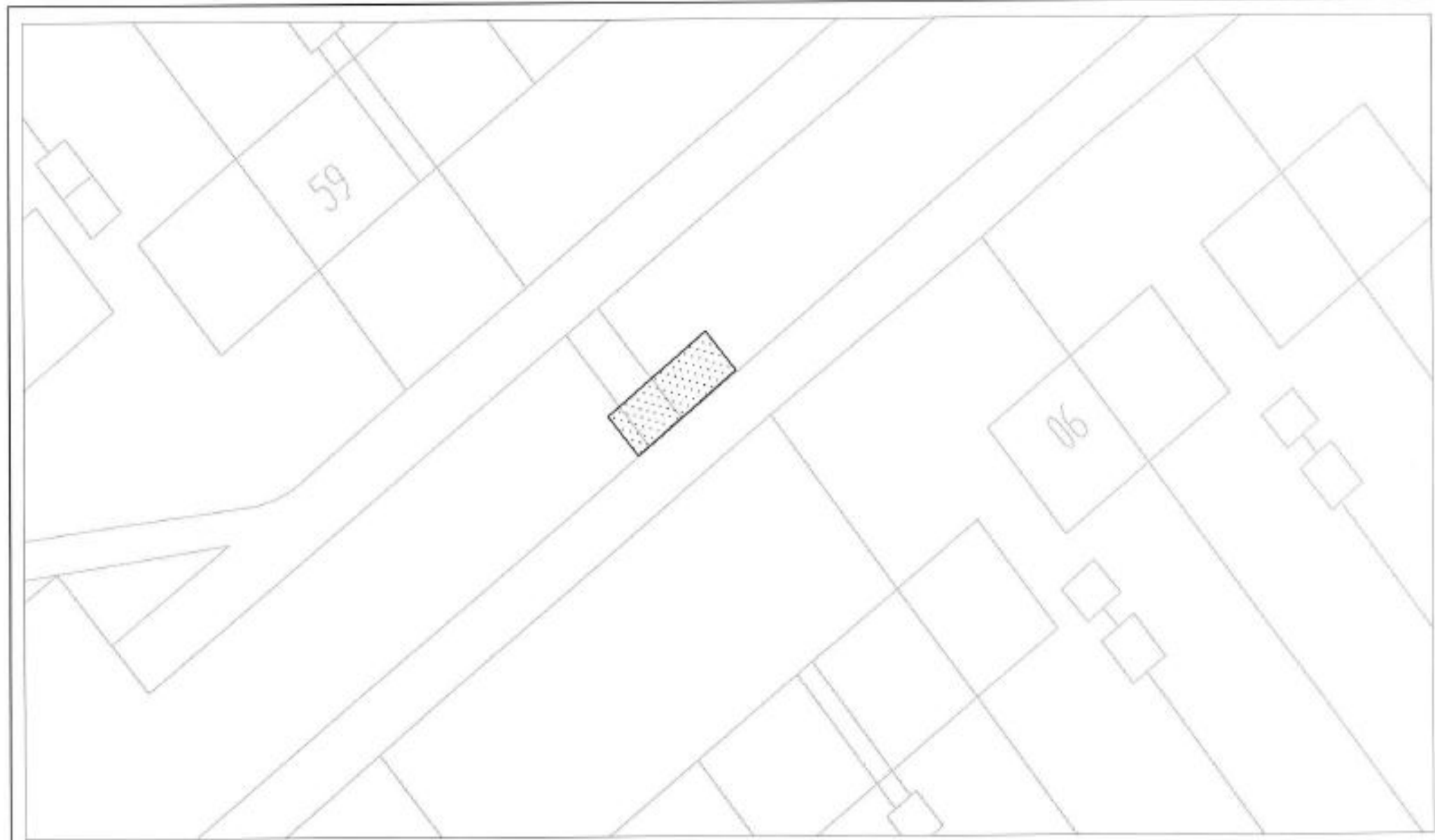

Outside 45 Prince Charles Avenue, Sittingbourne – New Disabled Persons’ Parking Bay/Formalising of Existing Bay

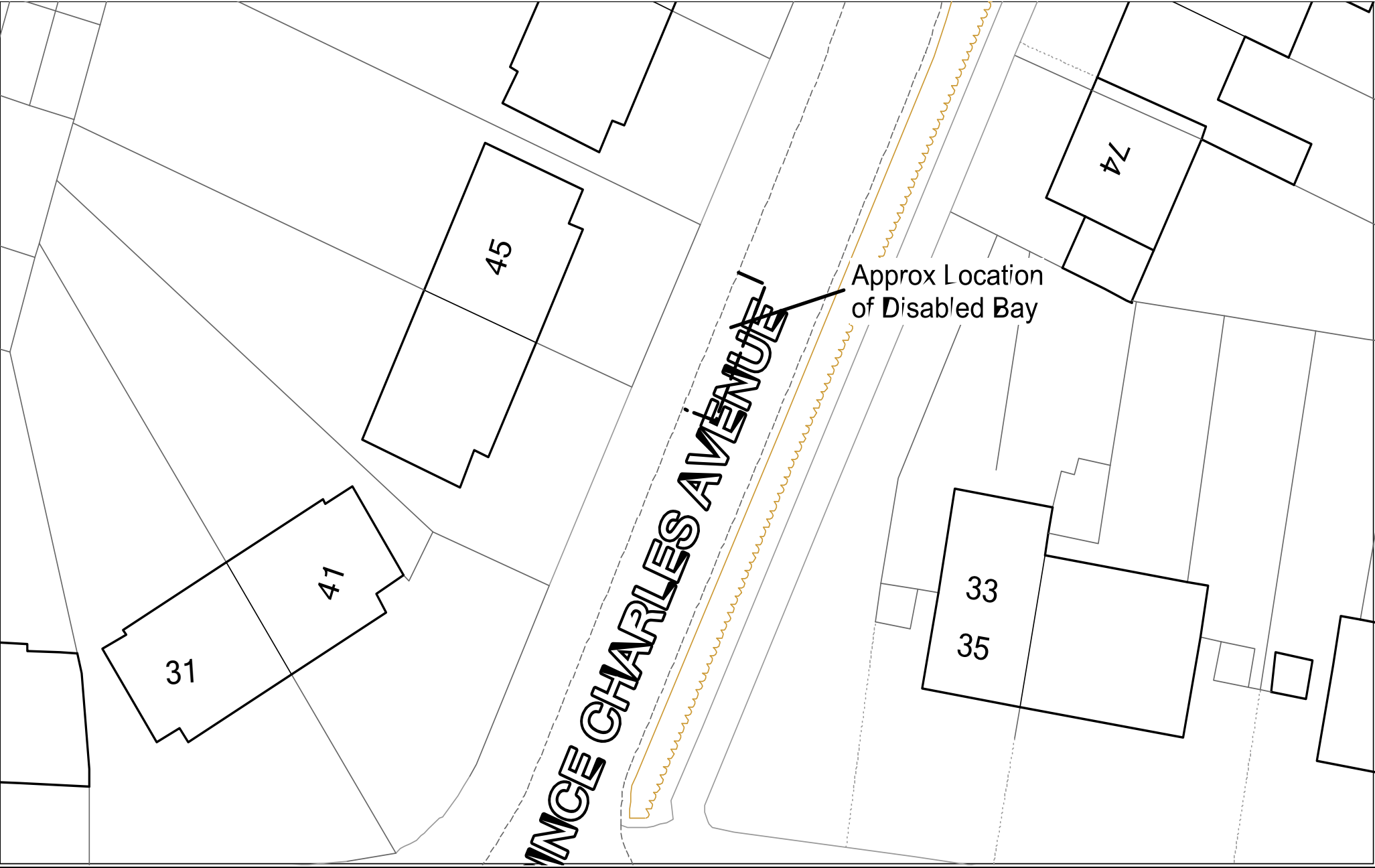

Outside 47 Prince Charles Avenue, Sittingbourne – New Disabled Persons' Parking Bay/Formalising of Existing Bay

